



GENIE[®] 133

Supreme Membrane Separator



Your best choice when high liquid handling capability is required!

The Genie[®] Supreme 100 Series™ can remove 100% of entrained liquid and particulates in gas samples, including aerosols. Unlike coalescing filters that may allow aerosols to pass through the filter element and become re-entrained, Genie[®] Membrane Separators™ reject aerosols on the surface of their membrane where they are removed through a drain/bypass. Only the gas sample will flow through the membrane to the analyzers, protecting them and other sampling components against liquid damage.

The Genie[®] Supreme Model 133 Membrane Separator™ combines your favorite features of the legacy Genie[®] Model 130 with the improved features of the Supreme Series™, including a threaded cover for easy maintenance and the option of Liquid Block Technology™ that prevents liquid from being forced across the membrane. The Model 133 has the same flow rate capacity as the Genie[®] Supreme Model 123 with a larger inlet cavity making it better suited for use in sampling applications where there is a significant amount of liquid present in the sample gas.

The Genie[®] Supreme Model 133 Membrane Separator™ can be mounted before a sample pump or analyzer to protect them from damage caused by liquids. It can also be probe mounted at the sample extraction point to prevent liquid from entering the sample system at locations where there is too much liquid entrained in the source to use a membrane tip probe. When probe mounted using our Probe Assembly, a liquid deflector is used before its inlet to prevent liquid slugs from entering the Model 133.

Technical Specifications

Maximum pressure rating	3,000 psig (206.8 Bar) Probe Assembly: 2,000 psig (138 Bar)
Temperature range	-15 °F (-26.1 °C) to 185 °F (85 °C) for Type 6/BTU membrane -15 °F (-26.1 °C) to 302 °F (150 °C) for Hi-Flow Backed membrane
Maximum recommended membrane flow rate (For higher flow rates contact the factory)	5,130 cc/min for Type 6/BTU membrane* 13,000 cc/min for Hi-Flow Backed membrane* <small>*Maximum flow results in approximately 2 psi membrane differential pressure with minimum of 70 psig inlet pressure</small>
Bypass flow rates	Requirement varies with application
Port sizes	Inlet, Outlet, & Bypass: 1/4" female NPT
Internal volume (cc) Listed with and without Liquid Block™ respectively	Total: 43.7, 44.9 Upstream of membrane: 40 Downstream of membrane: 3.7, 4.9
Wetted materials	Machined parts: 316/316L stainless steel / NACE compliant All other metal parts: stainless steel / NACE compliant Sealing material: Fluoroelastomer standard Membrane: Inert

Product Brief

Applications

- Continuous sampling from gas sources when large quantities of free liquids are continuously present
 - Natural gas gathering & processing
 - Continuous Emission Monitoring Systems (CEMS)
 - Some refinery & petrochemical gases

Benefits

- Probe mounting:
 - Prevents sample system contamination
 - Eliminates the need for a bypass or drain
- Mounting upstream of analyzer or pump:
 - Protects the analyzer from damage
 - Improves reliability
 - Decreases maintenance time and cost

Features

- Proven Genie[®] Membrane Technology™
- Optional Liquid Block Technology™
- Unique housing design
- Large internal volume for increased liquid tolerance



Model Numbering & Additional Part Numbers

Your model number is determined by your specific needs. Choose options below.

Sealing material	0 = fluoroelastomer	1 = perfluoroelastomer	(others available upon request)
Membrane type	6 = Type 6/BTU	7 = Hi-Flow Backed	
Liquid Block™ option	Blank = No Liquid Block™	LB = Liquid Block™	(not recommended for probe mounting)
Mounting bracket	Part # 133-509-SS (sold separately)		

Model number:

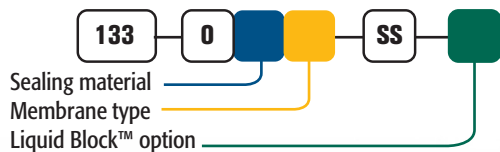

Replacement membrane kit number:

(Five membranes per kit. O-rings sold separately)

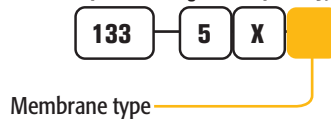

Assembly for probe mounting:

(Non-standard 760 probe sold separately. Contact factory.)



Membrane replacement sealing material number:

(One o-ring per kit.)

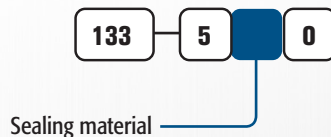

Dimensions

Individual product

Side View

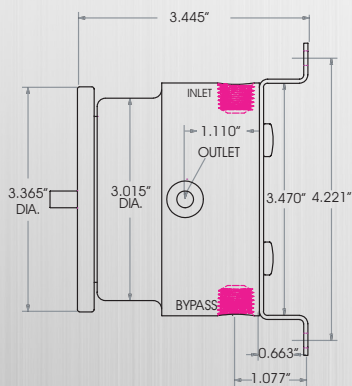

Front View

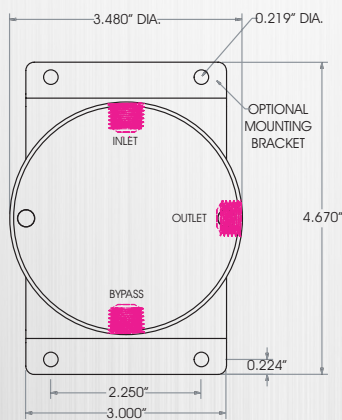

Probe mounted assembly

Front View

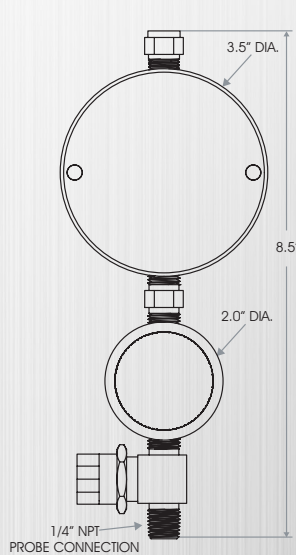

Side View

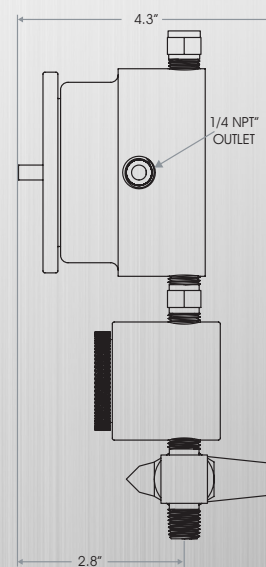

Refer to 760 or GPHV product sheet for probe dimensions and technical information.



Local Distributor

A+ Corporation is the leader in Analytically Correct™ Sample Extraction and Conditioning Systems.

Contact us for expert product application assistance.

sales@geniefilters.com > 225.644.5255 > Fax 225.644.3975

41041 Black Bayou Road, Gonzales, LA 70737 An ISO 9001:2008 Certified Company

U.S. Patents 5,476,586 and 7,555,964. Genie®, Genie® Membrane Technology™, and Genie® Membrane Separators™ are trademarks or registered trademarks of A+ Corporation, LLC. All other referenced trademarks are the property of their respective owners. © 2012 A+ Corporation. All rights reserved. SCC-133-PS_0116